

SPECIFICATION

MOTOR	Electronically Commutated Motor		
MOTOR TYPE	FL-ESF172/45M2S		
VOLTAGE (V)	230	Max Air flow(m³/h)	550±10%
FREQUENCY (Hz)	50/60	Noise(dBA)	≤63
INPUT POWER (W)	21±10%		
CURRENT (A)	0.18		
SPEED (r/min)	2500/1700		
FAN BLADES	Φ 172		
ROTATION	CCW (looking towards the shaft)		
AIRFLOW DIRECTION	Sucking		
INSULATION CLASS	B		
TEMPERATURE RISE	50K max (with load)		
PROTECTION CLASS	IP 54		
OPERATING TYPE	S1		
MOUNTING TYPE	Horizontal or Vertical		
AMBIENT TEMPERATURE	-30°C +50°C		
BEARINGS	ball bearings		
ELECTRICAL CONNECTION	VDE (H03VV-F) 3×0.5mm² lead wire 600 ±20mm free length, with 3 TYCO terminals 926883-1		
HI-POT TEST	3600V 1s		
WEIGHT PER UNIT	0.48kg		
PACKING	40PCS/CTN		
LIFE EXPECTANCY	50000 hours		

Technical requirements:

- 1.Fan flexible rotation, no clamping stagnation, abnormal sound and other bad phenomenon;
- 2.No oil and glue mark on the surface of the fan, no defects such as obvious deformation, mechanical mar,etc;
- 3.Lead wires surface without damage, the length according to the requirements of the drawings;
- 4.The motor is BLDC , it's protection functions include blocking protection,soft start, current-limiting protection ;
- 5.Rotation direction: The fan rotates ccw viewed from rotor;
6. 2 speeds programmed through NFC;
- 7.Main technical parameters of the fan according to the preceding table:

Performance curve:

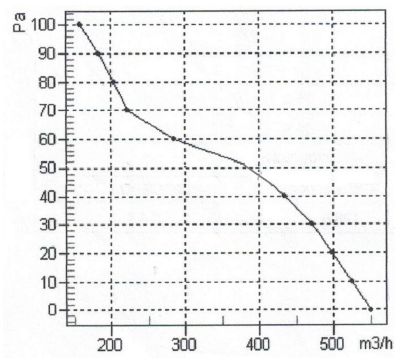

Label:

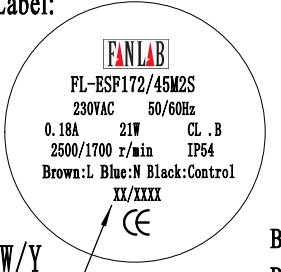

Wiring diagram:

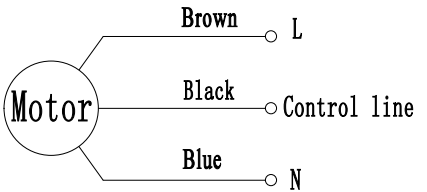

Black line open: n1 speed(MAX)
Black line connects with blue line or brown line: n2 speed(MIN)

	SIGN	DATE
DRN.BY	严仕鹏	2020.3.11
CHD.BY		
ENG.BY		
APP.BY		

FL-ESF172/45M2S

FL434

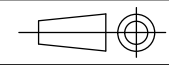

SCALE:
SHEET: 1 of