



INTERRUTTORE A PULSANTE ANTIVANDALO, 5A 250V AC, IP65, ACCIAIO INOX

INTERRUTTORE 5A, 250V AC (CE-VDE)
DIAMETRO 19MM
TIPOLOGIA: MOMENTANEO
LUMINOSO CON RING
GRADO DI PROTEZIONE IP65
CORPO E PULSANTE: ACCIAIO INOSSIDABILE
CONTATTI: LEGA ARGENTO

COD: **AV19A-T11MRB6**

COD. PRODUTTORE: **LAS1-AGQ**

MARCA: **ONPOW**



DISEGNO

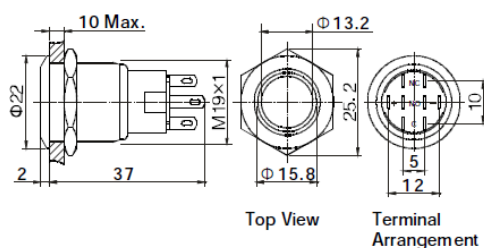

SPECIFICHE

Switch Rating

Rated Insulation Voltage U_i		250V			
Thermal Current I_{th}		5A			
Rated voltage		12V	24V	110V	220V
Rated	AC	Resistive load	—	1A	0.5A
	50/60Hz	Inductive load	—	0.7A	0.5A
Operation	DC	Resistive load	1A	0.2A	—
		Inductive load	0.7A	0.1A	—
Contact material		Silver Alloy			

Minimum load: 3V AC/DC, 5mA (Reference)
Application scope depends on operating environment and load type

Lamp Ratings

Lamp Type	LED Lamp (AC/DC)
LED Color	R G Y O B W
Life	40000 hours (Reference)
Rated Voltage	AC/DC6V, AC/DC12V, AC/DC110V AC/DC24V, AC/DC36V, AC/DC220V
Rated Current	About 15mA; About 2mA
Dropping life	Inner resistance; Outer resistance when using 6V lamp.
Lamp Circuit Diagram	Using AC/DC LED lamp, the terminals have no difference of anode and cathode; Using inner resistance, do not need connect outer resistance

a — R — LED — b

Note: DC LED and other voltage can be made to order

Terminal Description

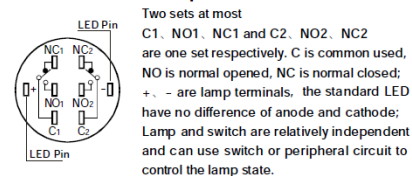

Switching Operation

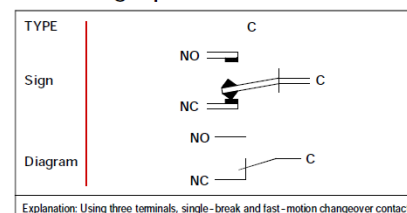

SPECIFICHE

Interruttore	Diametro	Contatti	Tipo di attuatore	Colore led	Tensione Led	Grado di protezione	Terminali	Materiale
Luminoso	19mm	1NO+1NC	Pulsante/ Momentaneo	Blu	6V	IP65	A saldare	Acciaio inossidabile